

Tuerca hexagonal **DIN 934**

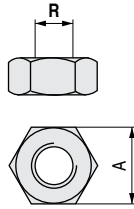

CODIGO	R	A	Material	Acabado	
9007.49	M4	7	acero	zincado	1.000
9007.45	M5	8	acero	zincado	1.000
9007.44	M6	10	acero	zincado	1.000
9007.40	M8	13	acero	zincado	500
9007.47	M10	17	acero	zincado	500
9007.75	1/4"	11	acero	zincado	1.000

Tuerca autoblocante **DIN 985**

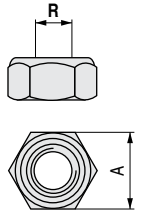

CODIGO	R	A	Material	Acabado	
122.37	M5	8	acero	zincado	1.000
122.38	M6	10	acero	zincado	1.000
122.35	M8	13	acero	zincado	1.000
122.39	M10	17	acero	zincado	500

Tuerca con arandela grafilada **DIN 6923**

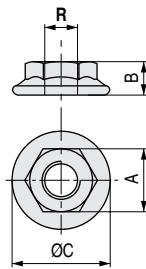

CODIGO	R	A	B	ØC	Material	Acabado	
9007.55	M5	8	5	11,8	acero	zincado	2.000
9007.54	M6	10	6	14,2	acero	zincado	1.000
9007.56	M8	13	8	17,9	acero	zincado	1.000
9007.57	M10	15	10	21,8	acero	zincado	500

**TUERCA CIEGA**

LATON  
BRASS

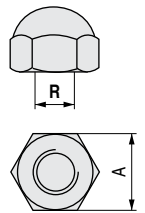

CODIGO	R	A	Material	Acabado	
647.5	M6	10	latón	níquel	500
647.6	M8	13	latón	níquel	250

Tuerca palomilla **DIN 315**

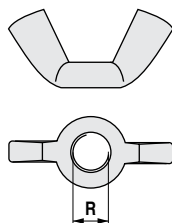

CODIGO	R	Material	Acabado	
365.302	M5	hierro	zincado	1.000
365.270	M6	hierro	zincado	500
365.294	M8	hierro	zincado	300

**DUVER 12** Tuerca expansible

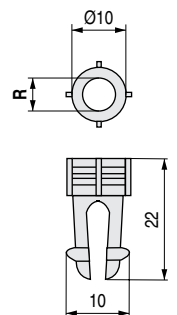

CODIGO	R	Material	Acabado	
9030.12	1/4"	zamak	natural	3.000
9030.13	M6	zamak	natural	3.000